



CITY OF ROCKLIN
PLANNING DEPARTMENT

**Required Information for Zoning Review of
Additions, Patio Covers, and Accessory Structures**

In addition to building code requirements, your proposed construction must conform to the requirements of the zoning ordinance. The physical development standards that apply to all buildings, additions, and structures, including patio covers and arbors, are found in the regulations for each zone in the zoning ordinance and related documents. You may call the Planning Department at 625-5160 to find out what development standards are applicable to your lot.

In general, the development standards include the following:

Setbacks: the distance structures must be located from each of your property lines, front, back and sides

Indicate the distance in feet from proposed structures to the property lines to demonstrate conformance with setback requirements. Your perimeter fence line may not be the same as your property line.

Height of structures

Lot Coverage: the square footage of the first floor of all structures on the lot divided by the square footage of the lot. This is expressed in a percentage. For each zone, there is a maximum percent of the lot that can be covered with structures.

Present the following information on the site plan to demonstrate conformance with setback requirements:

A) *Area of existing and proposed structures (first floor only) in square feet.*

All structures over 30 inches in height count toward lot coverage, including porches, decks, arbors, and covered patios.

B) *Area of the lot in square feet.*

C) *Percent Lot Coverage ($A \div B$)*

Please indicate proposed and existing setbacks and lot coverage on your plot plan. The sample plot plan on the back of this sheet demonstrates how to present this information.

If you need help obtaining information, some of the information may be available at the Building or Planning offices. The size of your lot and the square footage of existing structures may be available in the original building permit files. Building department staff can assist you in obtaining this information, if it is available. You must still calculate the existing and proposed lot coverage yourself. You can contact the Building Department at 625-5120.

If your house was built some time ago, building permit information will probably not be available. Please contact the Planning Department staff at 625-5160 or at the City Administration Building for assistance.

City of Rocklin Building Division

3970 Rocklin Road Rocklin CA 95677 (916) 625-5120 (Fax) 625-5195

OWNER:
FRED G. HAMILTON
123 MAIN ST.

ASSESSOR'S PARCEL
NUMBER: 167-034-079

PREPARED BY:
FRANK L. DOE

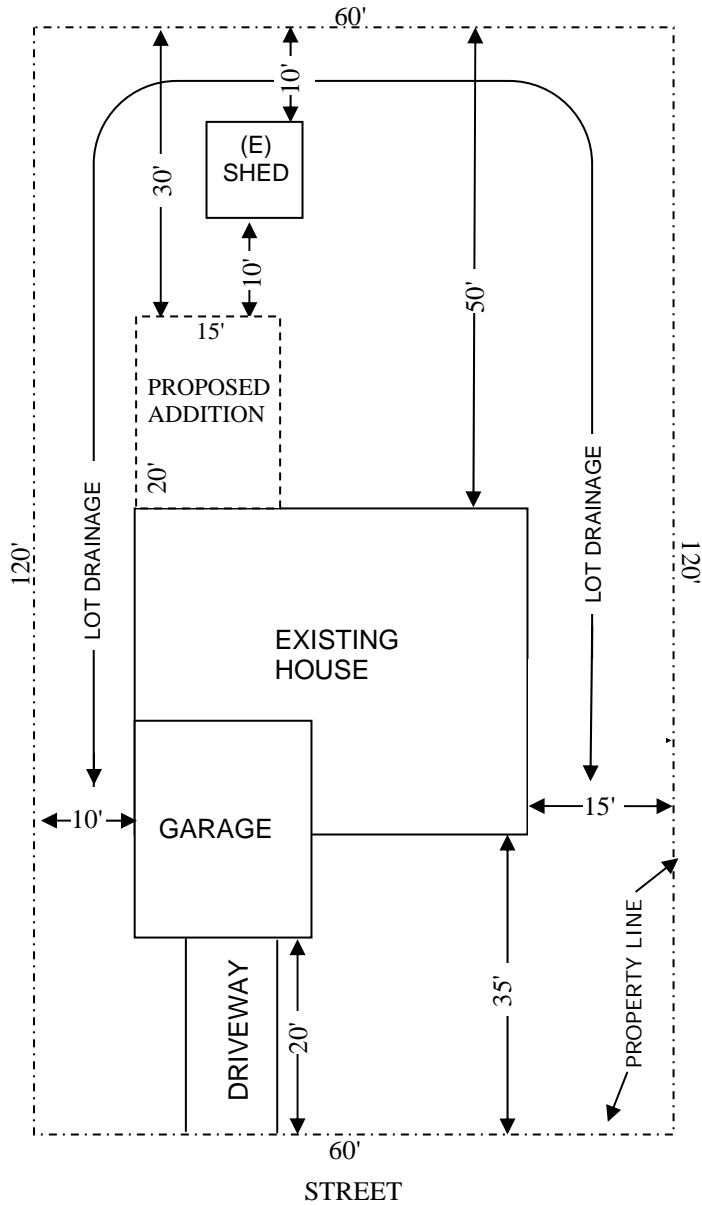

SCALE: 1"=20'

SITE PLAN (SAMPLE)

SQUARE FOOTAGE OF ALL STRUCTURES: _____ (A)
(FIRST FLOOR ONLY)

SQUARE FOOTAGE OF LOT: _____ (B)

LOT COVERAGE: _____ %
(A ÷ B)