

**STATION DESCRIPTION & SKETCH**

JN 11559-00 - Project Name: CITY OF ROCKLIN CONTROL NETWORK

QUADRANGLE NAME: \_\_\_\_\_ STATION NAME: TBM S (R9-4)

Approximate Latitude: 38° 46' 50.01" N Approximate Longitude: 121° 15' 49.62" W

Described by: PETER BALDO Date: 4/3/03

To reach the point T-80 TO ROCKLIN RD. TAKE LEFT ON TO TAYLOR RD (TAYLOR RD. THEN TURNS INTO PACIFIC) TURN RIGHT ON TO SUNSET. GO UP SUNSET (+ or -) 1 1/2 MILE TO A LEFT TURN ON S. WHITNEY BLVD. TAKE S. WHITNEY BLVD TO INTX 5 STAR BLVD AND S. WHITNEY (BLVD). BOLT ON TRAFFIC SIGNAL POLE NORTHEAST QUADRANT INTX.

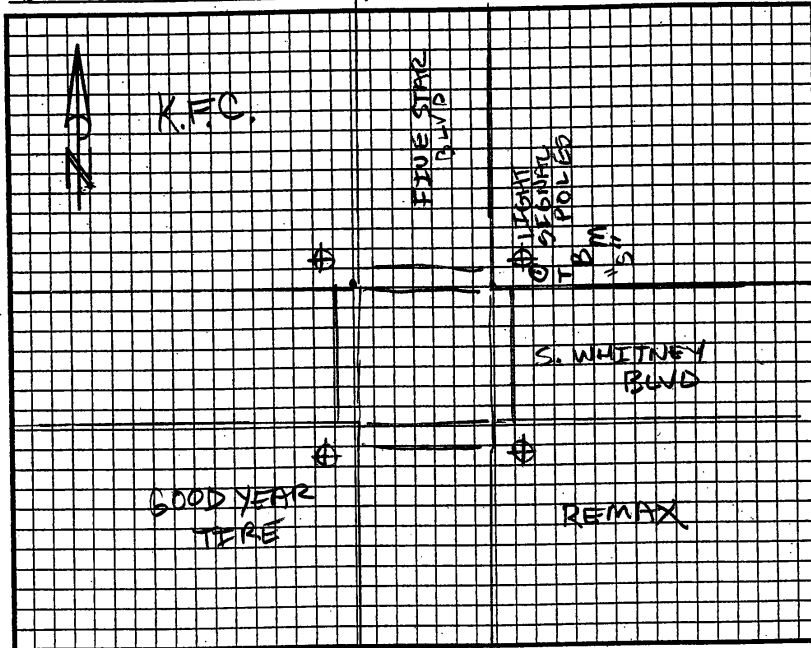

The point is marked by BOLT ON TRAFFI SIGNAL and is \_\_\_\_\_ the ground.  
POLE NORTHEAST QUADRANT OF INTX. SOUTHEAST  
FACE OF BASE SIGNAL POLE. THE PT. IS .42' ABOVE  
SURFACE