

STATION DESCRIPTION & SKETCH

JN 11559-00 - Project Name: CITY of ROCKHILL CONTROL NETWORK

QUADRANGLE NAME: ROCKHILL STATION NAME: E 1200 (R8-15)

Approximate Latitude: 38-47-08 N Approximate Longitude: 121-14-32 W

Described by: D. LEMINGTON Date: 7-29-02

To reach the point FROM INTK of FARRON ST & UP RR TRACKS - PROCEED SOUTH ON WEST SIDE of TRACKS 500'± ALONG DIRT RD, PROCEED WEST UP SMALL HILL - 40'± WEST of OLD FENCE TO STATION ON ROCK OUTCROP

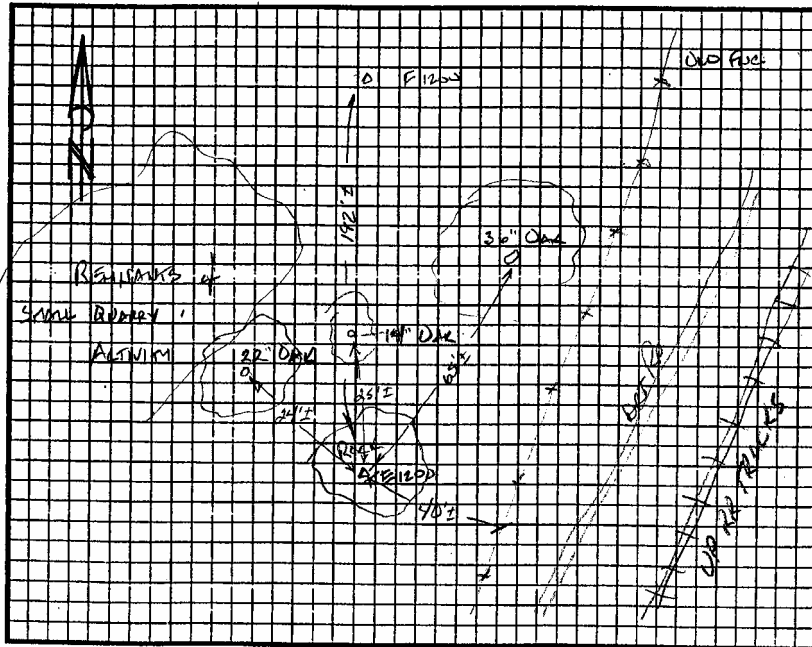

The point is marked by 3/8\" USC #65 DISK IN ROCK and is FLUSH WITH THE ^{ROCK} GROUND.
THE STATION IS 40'± WESTERLY of OLD FENCE & 24'± SOUTHWEST of 22\" OAK ON EDGE of OLD ROCK QUARRY ACTIVITY SITE & 25'± SOUTH of 14\" OAK & 65'± SOUTHWEST of 36\" OAK & 192'± SOUTH of STATION F. 1200