

ANDREGG, INC.

SURVEYING • MAPPING • GEOMATICS

STATION DESCRIPTION & SKETCH

JN 11559-00 Project Name: City of Rocklin Control Network (R7-7)

QUADRANGLE NAME: ROCKLIN STATION NAME: TBM 444 [RM 40]

Approximate Latitude: 38° 49' 14.66" N Approximate Longitude: 121° 13' 52.53" W

Described by: PETER BALDO Date: 4/3/03

To reach the point FROM INTX OF MIDAS AVE. AND CLOVER VALLEY ROAD GO NORTH ON CLOVER VALLEY ROAD 1.3 MILES. TURN LEFT (WEST) ON RAWHIDE ROAD PT. IS (+or-) 100' WEST OF Q CLOVER VALLEY ROAD INTX WITH RAWHIDE ROAD. PT. ON HEADWALL BEHIND GRANITE PILLAR ON SOUTH FACE CREEK CROSSING.

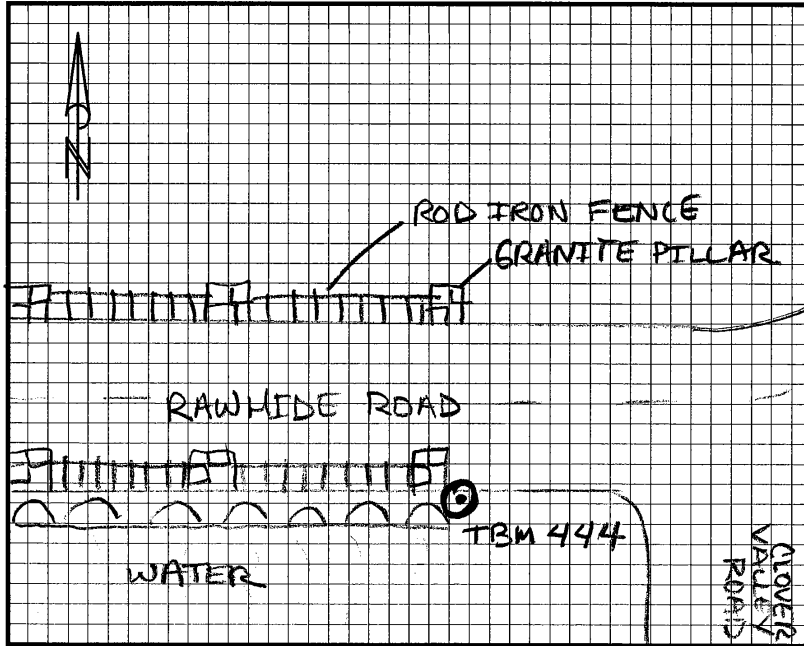

The point is marked by PK-NAIL W/WASHER and is FLUSH the ground. .6' NORTH OF SOUTH FACE OF HEAD WALL GRANITE PILLAR. 1.3' NORTH OF CENTER GRANITE PILLAR.

