

200 F-7

ANDREGG, INC.

SURVEYING • MAPPING • GEOMATICS

STATION DESCRIPTION & SKETCH

JN 11559-00 - Project Name: City of Rocklin Control Network

QUADRANGLE NAME: ROCKLIN STATION NAME: RM 45 (R 6-9)

Approximate Latitude: 39°48'37.53"N Approximate Longitude: 121°13'13.85"W

Described by: W. WILSON Date: 12-02-02

To reach the point FROM DELMAR AVE / PACIFIC ST GO
NORTH ON DELMAR 0.5 MILES TO DRIVEWAY ON
LEFT # 3994 WESTALY ON DRIVE TO WOODEN BRIDGE
OVER ANTALOPE CREEK, DAM WILL BE AT RIGHT
END OF

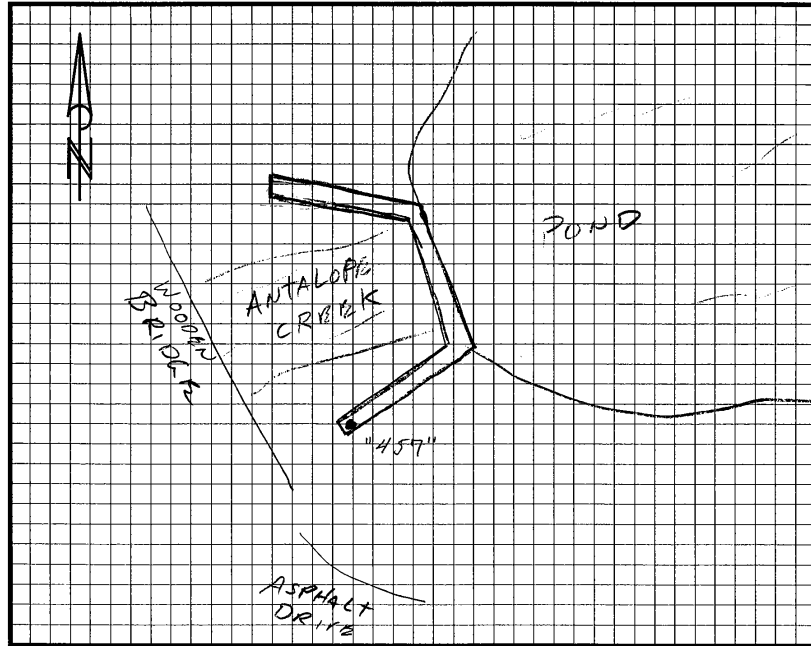

The point is marked by PK WASHER and is FLUSH W/ the ground.
ON SW END OF SW WING WALL OF DAM

