

# ANDREGG, INC.

SURVEYING • MAPPING • GEOMATICS

## STATION DESCRIPTION & SKETCH

JN 11559-00 Project Name: City of Rocklin Control Network

QUADRANGLE NAME: Rocklin STATION NAME: M1200 (USGS) (R1-1)

Approximate Latitude: 38° 48' 33.20" N Approximate Longitude: 121° 12' 37.37" W

Described by: W. WILSON Date: 12-02-02

To reach the point FROM THE INTERSECTION OF SIERRA COLLEGE BLVD & TAYLOR RD GO NORTH 100'± TO RAILROAD TRACKS THENCE SOUTHWESTERLY ALONG THE SOUTHSIDE OF THE TRACKS 0.35 MILES TO A CULVERT STRUCTURE 400'± SW OF THE WESTERLY CORNER OF VALLEY ROCK YARD

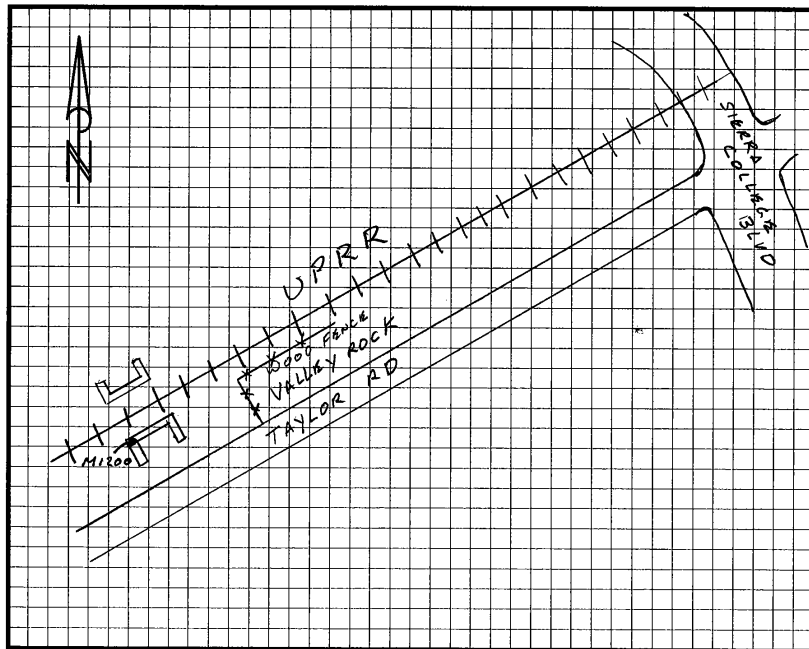

The point is marked by USGS BRASS CAP and is FLUSH w/ the ground. CAP IS IN THE WEST MOST CORNER OF SOUTHERLY HEADWALL & IS MARKED "M1200 1969"

