

STATION DESCRIPTION & SKETCH

JN 11559-00 Project Name: City of Rocklin Control Network W

QUADRANGLE NAME: Rocklin STATION NAME: RM 118⁴²¹ (23-10)

Approximate Latitude: 38° 47' 18.94" Approximate Longitude: 121° 13' 38.12"

Described by: W. W. LSON Date: 12-02-02

To reach the point FROM THE INTERSECTION OF ROCKLIN RD & GRANITE DR.
GO WEST ALONG ROCKLIN RD 300'± TO POINT AT THE NE
CORNER OF DI JUST WEST OF DRIVE CUT ON EAST SIDE OF
SUCKER CREEK

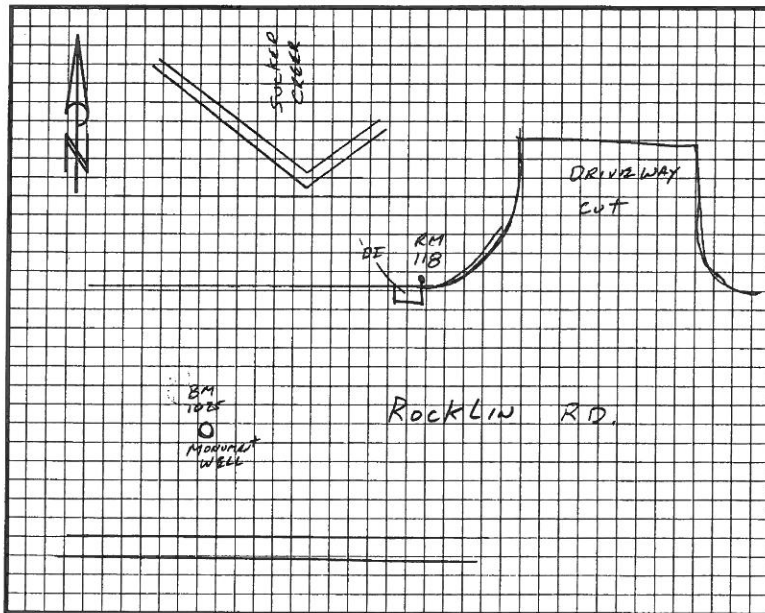

The point is marked by PK ANDREGG WASHER and is FLUSH W/ the ground.
PK WASHER INTO TOP OF CURB AT CURB RETURN & DI ON
SUCKER CREEK CROSSING

